

## **Model 007 Cartridge Circulator**

The Taco 007 Cartridge Circulator is the most popular hydronic circulator sold today. With its field serviceable cartridge design, the compact 007 provides quiet, efficient operation and unmatched reliability. The self-lubricating, maintenance free design and flow characteristics make it the ideal hydronic circulator for a wide range of applications.



**HYDRONIC COMPONENTS & SYSTEMS**

**Do it once.  
Do it right.™**  **Taco®**

# Submittal Data Information Model 007 Cartridge Circulators

Submittal Data # 101-029  
Supersedes: 101-029 Dated: 06/15/02

Effective: 09/1/03

## Features

- Standard High Capacity Output-Compact Design
- Quiet, Efficient Operation
- Direct Drive-Low Power Consumption
- Unique Replaceable Cartridge Design-Field Serviceable
- Self Lubricating
- No Mechanical Seal
- Unmatched Reliability-Maintenance Free
- Universal Flange to Flange Dimensions
- Cast Iron or Bronze Construction

## Materials of Construction

Casing (Volute):	Cast Iron or Bronze
Stator Housing:	Steel
Cartridge:	Stainless Steel
Impeller:	Non-Metallic
Shaft:	Ceramic
Bearings:	Carbon
O-Ring & Gaskets:	EPDM

## Model Nomenclature

F - Cast Iron, Flanged  
BF - Bronze, Flanged  
**Variations:**  
Z - Zoning Circulator  
J - Bronze Cartridge with Cast Iron Casing

## Performance Data

Flow Range: 0 – 20 GPM  
Head Range: 0 – 11 Feet  
Minimum Fluid Temperature: 40°F (4°C)  
Maximum Fluid Temperature:  
Cast Iron: 240°F (115°C)  
Bronze: 230°F (110°C)  
Maximum Working Pressure: 125 psi  
Connection Sizes: 3/4", 1", 1-1/4", 1-1/2" Flanged

 **US LISTED**  
**FOR INDOOR USE ONLY**

## Application

The Taco 007 is a cartridge style, maintenance free, wet-rotor, in-line, single stage circulator pump. It is designed for quiet operation in Hydronic heating, Radiant heating, Hydro-Air fan coils, Indirect water heaters, Chilled fresh water, and Domestic Water Recirculation systems. Available in Cast Iron or Bronze construction with universal flanged connections. The unique replaceable cartridge contains all of the moving parts and allows the circulator to be easily serviced instead of replacing the entire unit. Ideal for a wide range of applications.

## Pump Dimensions & Weights

Model	Casing	A		B		C		D		F		G		Ship Wt.	
		in.	mm	in.	mm	in.	mm	in.	mm	in.	mm	in.	mm	lbs.	Kg
007-F5	Cast Iron	6-1/8	156	4-1/2	114	3-3/16	81	2-15/16	75	4-3/4	121	6-3/8	162	8.0	3.6
007-BF5	Bronze	6-1/8	156	4-1/2	114	3-3/16	81	2-15/16	75	4-3/4	121	6-3/8	162	8.0	3.6

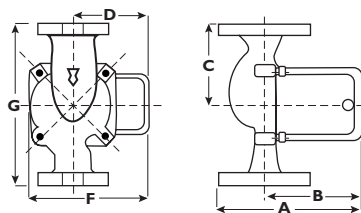

## Mounting Positions

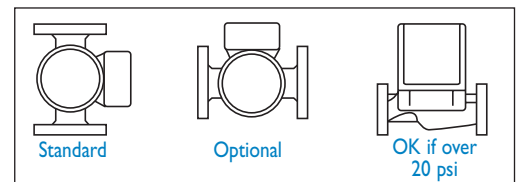

## Electrical Data

Model	Volts	Hz	Ph	Amps	RPM	HP
007-F5	115	60	1	.70	3250	1/25
007-BF5	115	60	1	.76	3250	1/25
Motor Type	Permanent Split Capacitor Impedance Protected					
Motor Options	220/50/1, 220/60/1, 230/60/1, 100/110/50/60/1					

## Flange Orientation

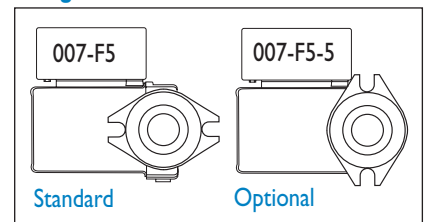

## Performance Field - 60Hz

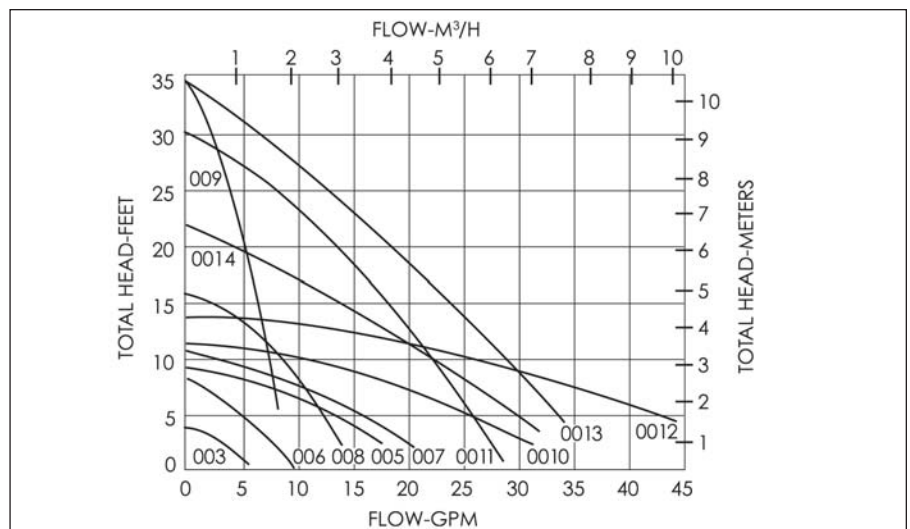

## HYDRONIC COMPONENTS & SYSTEMS

Do it once.  
Do it right.™ 

Taco Inc., 1160 Cranston Street, Cranston, RI 02920 / (401) 942-8000 / Fax (401) 942-2360  
Taco (Canada) Ltd., 6180 Ordan Drive, Mississauga, Ontario L5T 2B3 / (905) 564-9422 / Fax (905) 564-9436  
[www.taco-hvac.com](http://www.taco-hvac.com)